

78°57'30"W

78°55'0"W

Legend

- One Mile Radius
- Quarter Mile Area of Review

Pennsylvania General Energy Company, L.L.C.

PGE
Area of Review (topo)

Pennsylvania	Indiana County	Date: 10 May, 2013
Area of review.mxd		ml

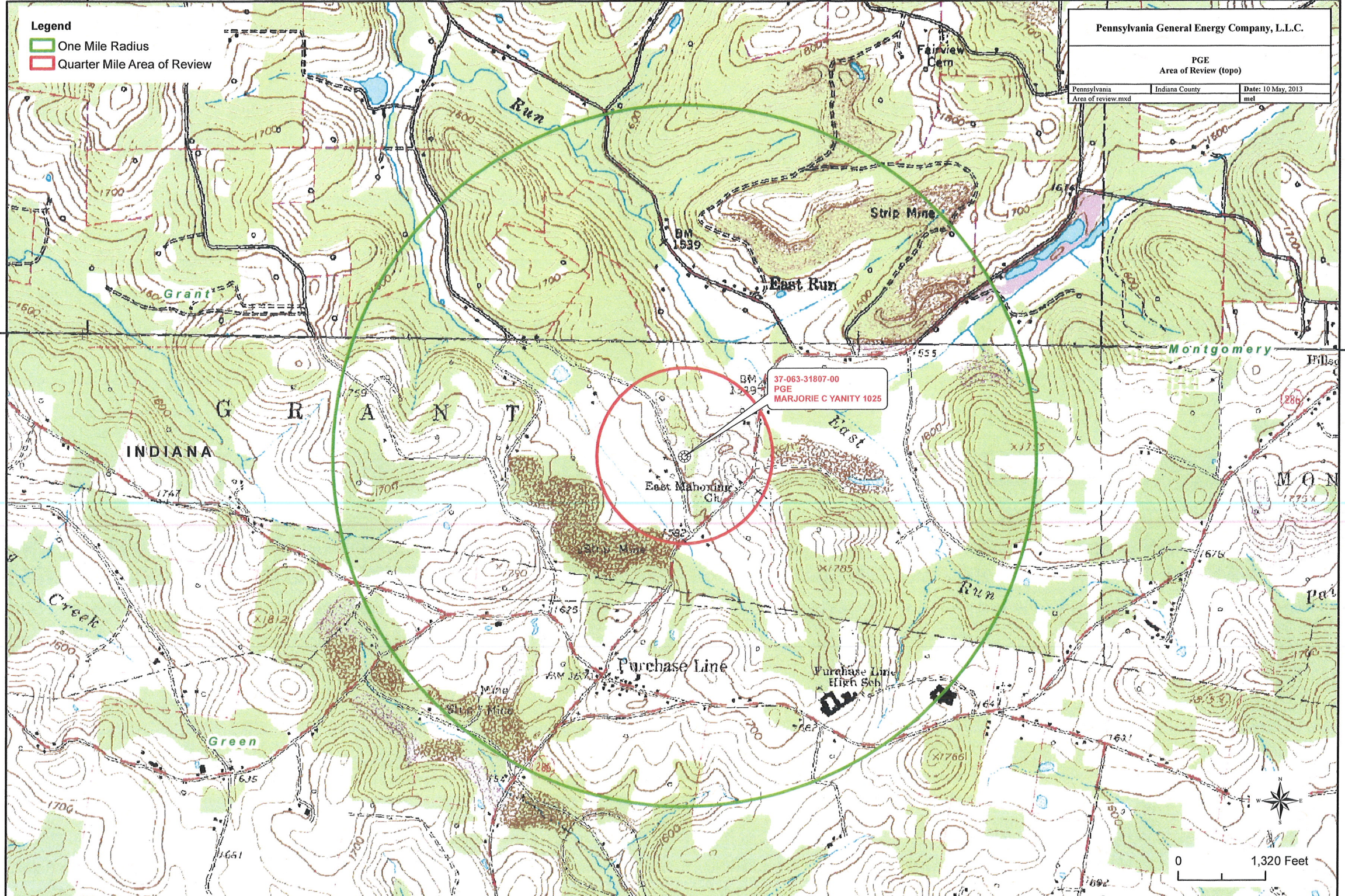

37-063-31807-00
 PGE
 MARJORIE C YANITY 1025

0 1,320 Feet

78°57'30"W

Pennsylvania General Energy Company, L.L.C.

PGE		
Area of Review (aerial)		
Pennsylvania	Indiana County	Date: 10 May, 2013
Area of review.mxd		mel

Legend

- One Mile Radius
- Quarter Mile Area of Review

40°45'0"N

40°45'0"N

Grant

Montgomery

INDIANA

37-063-31807-00
 PGE
 MARJORIE C YANITY 1025

Green



0 1,320 Feet

Image courtesy of USGS/CG 2115/US Forest Corporation

bing



78°57'30"W

78°55'0"W

78°57'30"W

78°55'0"W

Legend

-  One Mile Radius
-  Quarter Mile Area of Review

Pennsylvania General Energy Company, L.L.C.

PGE
Area of Review (topo)

Pennsylvania	Indiana County	Date: 10 May, 2013
Area of review.mxd		met

40°45'0"N

40°45'0"N

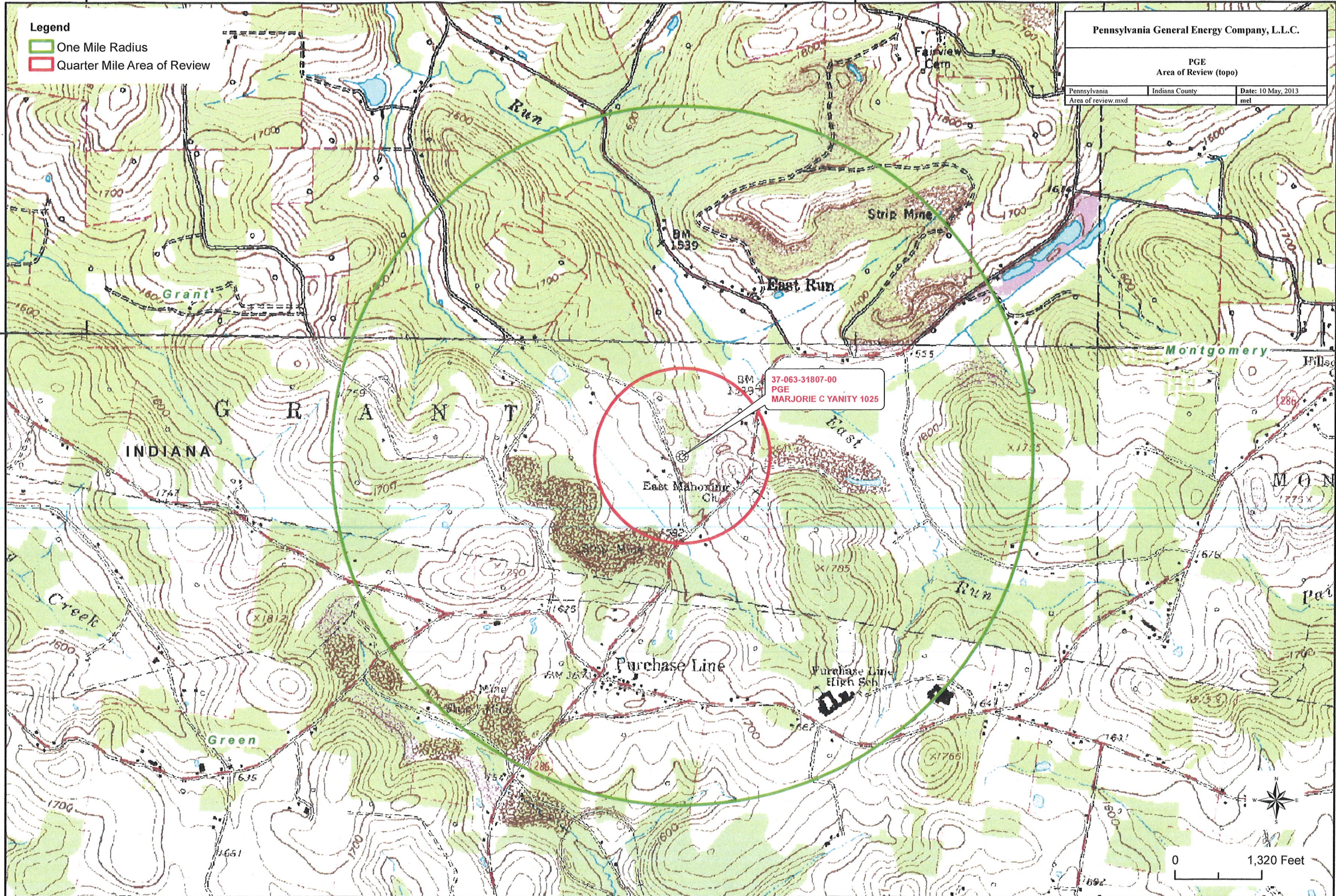

37-063-31807-00
PGE
MARJORIE C YANITY 1025

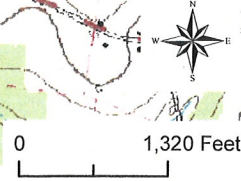

78°57'30"W

78°55'0"W

Legend

- One Mile Radius
- Quarter Mile Area of Review

Pennsylvania General Energy Company, L.L.C.

PGE
Area of Review (hillshade)

Pennsylvania	Indiana County	Date: 10 May, 2013
Area of review.mxd		mel

40°45'0"N

40°45'0"N

Grant

Montgomery

INDIANA

37-063-31807-00
PGE
MARJORIE C YANITY 1025

Green

